

ELEVATION CERTIFICATE

Important: Follow the instructions on pages 1-9.

Copy all pages of this Elevation Certificate and all attachments for (1) community official, (2) insurance agent/company, and (3) building owner.

SECTION A - PROPERTY INFORMATION	FOR INSURANCE COMPANY USE
A1. Building Owner's Name <u>ATLAS INVESTMENTS</u>	Policy Number:
A2. Building Street Address (including Apt., Unit, Suite, and/or Bldg. No.) or P.O. Route and Box No. <u>103 South Hwy 101</u>	Company NAIC Number:
City <u>WARRENTON</u>	State <u>OREGON</u>
	ZIP Code <u>97146</u>
A3. Property Description (Lot and Block Numbers, Tax Parcel Number, Legal Description, etc.) <u>PORTION OF BLOCKS 2, 3 & 4 "MERIWETHER" T&N, ROW, SEC 23 CB WM</u>	
A4. Building Use (e.g., Residential, Non-Residential, Addition, Accessory, etc.) <u>NON-RESIDENTIAL</u>	
A5. Latitude/Longitude: Lat. <u>46.162259</u> Long. <u>-123.898047</u> Horizontal Datum: <input type="checkbox"/> NAD 1927 <input checked="" type="checkbox"/> NAD 1983	
A6. Attach at least 2 photographs of the building if the Certificate is being used to obtain flood insurance.	
A7. Building Diagram Number <u>1A</u>	
A8. For a building with a crawlspace or enclosure(s):	
a) Square footage of crawlspace or enclosure(s) _____ sq ft	
b) Number of permanent flood openings in the crawlspace or enclosure(s) within 1.0 foot above adjacent grade _____	
c) Total net area of flood openings in A8.b _____ sq in	
d) Engineered flood openings? <input type="checkbox"/> Yes <input type="checkbox"/> No	
A9. For a building with an attached garage:	
a) Square footage of attached garage _____ sq ft	
b) Number of permanent flood openings in the attached garage within 1.0 foot above adjacent grade _____	
c) Total net area of flood openings in A9.b _____ sq in	
d) Engineered flood openings? <input type="checkbox"/> Yes <input type="checkbox"/> No	

SECTION B - FLOOD INSURANCE RATE MAP (FIRM) INFORMATION

B1. NFIP Community Name & Community Number <u>410033 CITY OF WARRENTON</u>		B2. County Name <u>CLATSOP</u>		B3. State <u>OR</u>	
B4. Map/Panel Number <u>41007</u>	B5. Suffix <u>CO217E</u>	B6. FIRM Index Date <u>3/17/2010</u>	B7. FIRM Panel Effective/ Revised Date <u>9/17/2010</u>	B8. Flood Zone(s) <u>AE</u>	B9. Base Flood Elevation(s) (Zone AO, use Base Flood Depth) <u>12.00</u>

B10. Indicate the source of the Base Flood Elevation (BFE) data or base flood depth entered in Item B9:
 FIS Profile FIRM Community Determined Other/Source: _____

B11. Indicate elevation datum used for BFE in Item B9: NGVD 1929 NAVD 1988 Other/Source: _____

B12. Is the building located in a Coastal Barrier Resources System (CBRS) area or Otherwise Protected Area (OPA)? Yes No
 Designation Date: _____ CBRS OPA

ELEVATION CERTIFICATE

OMB No. 1660-0008
Expiration Date: November 30, 2018

IMPORTANT: In these spaces, copy the corresponding information from Section A.			FOR INSURANCE COMPANY USE
Building Street Address (including Apt., Unit, Suite, and/or Bldg. No.) or P.O. Route and Box No. <u>103 South Hwy 101</u>			Policy Number:
City <u>WARRENTON</u>	State <u>OR</u>	ZIP Code <input checked="" type="checkbox"/> <u>97146</u>	Company NAIC Number

SECTION C – BUILDING ELEVATION INFORMATION (SURVEY REQUIRED)

C1. Building elevations are based on: Construction Drawings* Building Under Construction* Finished Construction
*A new Elevation Certificate will be required when construction of the building is complete.

C2. Elevations – Zones A1–A30, AE, AH, A (with BFE), VE, V1–V30, V (with BFE), AR, AR/A, AR/AE, AR/A1–A30, AR/AH, AR/AO. Complete Items C2.a–h below according to the building diagram specified in Item A7. In Puerto Rico only, enter meters.

Benchmark Utilized: 0410 01 1966 Vertical Datum: 13 64

Indicate elevation datum used for the elevations in items a) through h) below.

NGVD 1929 NAVD 1988 Other/Source: _____

Datum used for building elevations must be the same as that used for the BFE.

Check the measurement used.

- a) Top of bottom floor (including basement, crawlspace, or enclosure floor) 10.25 feet meters
- b) Top of the next higher floor _____ feet meters
- c) Bottom of the lowest horizontal structural member (V Zones only) _____ feet meters
- d) Attached garage (top of slab) _____ feet meters
- e) Lowest elevation of machinery or equipment servicing the building (Describe type of equipment and location in Comments) 10.25 feet meters
- f) Lowest adjacent (finished) grade next to building (LAG) 9.9 feet meters
- g) Highest adjacent (finished) grade next to building (HAG) 12.3 feet meters
- h) Lowest adjacent grade at lowest elevation of deck or stairs, including structural support _____ feet meters

SECTION D – SURVEYOR, ENGINEER, OR ARCHITECT CERTIFICATION

This certification is to be signed and sealed by a land surveyor, engineer, or architect authorized by law to certify elevation information. I certify that the information on this Certificate represents my best efforts to interpret the data available. I understand that any false statement may be punishable by fine or imprisonment under 18 U.S. Code, Section 1001.

Were latitude and longitude in Section A provided by a licensed land surveyor? Yes No Check here if attachments.

Certifier's Name License Number
DAVID A. FOSTER OPLS 1934

Title
OWNER / PRESIDENT

Company Name
FOSTER SURVEYING INC

Address
3517 SE 193RD AVE

City State ZIP Code
CAMAS WA. 98607

Signature Date Telephone Ext.
[Signature] 1/18/20 503-997-1100

REGISTERED
PROFESSIONAL
LAND SURVEYOR

OREGON
DECEMBER 16, 1980
DAVID A. FOSTER
1934

RENEWS: 12-31-21

Copy all pages of this Elevation Certificate and all attachments for (1) community official, (2) insurance agent/company, and (3) building owner.

Comments (including type of equipment and location, per C2(e), if applicable)

BUILDING PHOTOGRAPHS

ELEVATION CERTIFICATE

See Instructions for Item A6.

OMB No. 1660-0008

Expiration Date: November 30, 2018

IMPORTANT: In these spaces, copy the corresponding information from Section A.			FOR INSURANCE COMPANY USE	
Building Street Address (including Apt., Unit, Suite, and/or Bldg. No.) or P.O. Route and Box No. 103 Scout Hwy 101			Policy Number:	
City WARRENTON	State OR	ZIP Code <input checked="" type="checkbox"/> 97146	Company NAIC Number	

If using the Elevation Certificate to obtain NFIP flood insurance, affix at least 2 building photographs below according to the instructions for Item A6. Identify all photographs with date taken; "Front View" and "Rear View"; and, if required, "Right Side View" and "Left Side View." When applicable, photographs must show the foundation with representative examples of the flood openings or vents, as indicated in Section A8. If submitting more photographs than will fit on this page, use the Continuation Page.



Photo One

Photo One Caption Looking Southwesterly - NE Side Building

Clear Photo One



Photo Two

Photo Two Caption Looking Northwesterly Southwesterly Side Bldg.

Clear Photo Two

ELEVATION CERTIFICATE

BUILDING PHOTOGRAPHS

Continuation Page

OMB No. 1660-0008

Expiration Date: November 30, 2018

IMPORTANT: In these spaces, copy the corresponding information from Section A.			FOR INSURANCE COMPANY USE
Building Street Address (including Apt., Unit, Suite, and/or Bldg. No.) or P.O. Route and Box No. 103 South Hwy 101			Policy Number:
City WARRENTON OR	State	ZIP Code <input checked="" type="checkbox"/> 97146	Company NAIC Number

If submitting more photographs than will fit on the preceding page, affix the additional photographs below. Identify all photographs with: date taken; "Front View" and "Rear View"; and, if required, "Right Side View" and "Left Side View." When applicable, photographs must show the foundation with representative examples of the flood openings or vents, as indicated in Section A8.

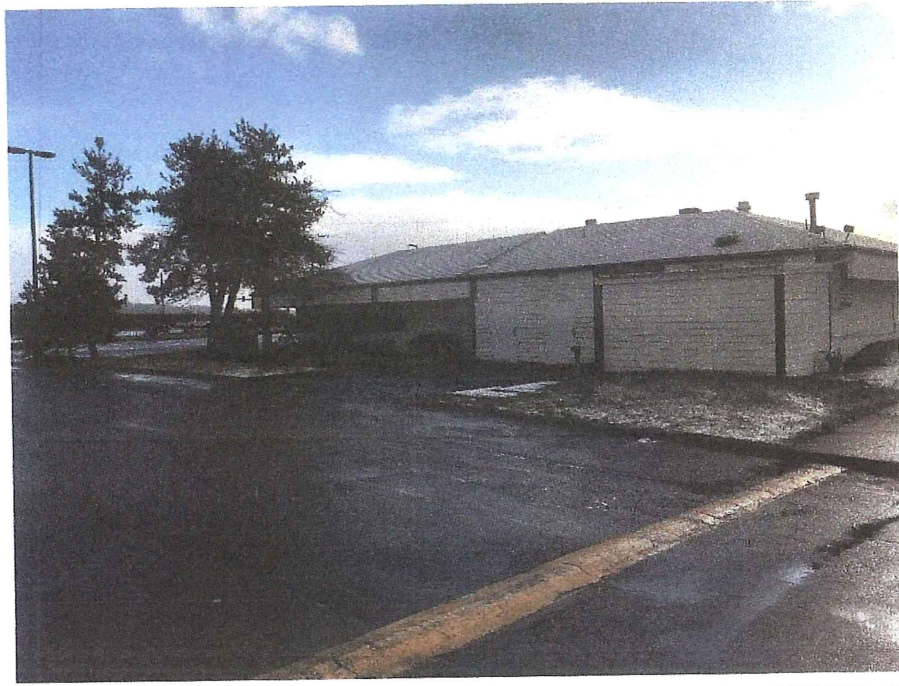

Photo Three

Photo Three Caption LOOKING EASTERN - NORTHWESTERNLY FACE BUILD.

Clear Photo Three

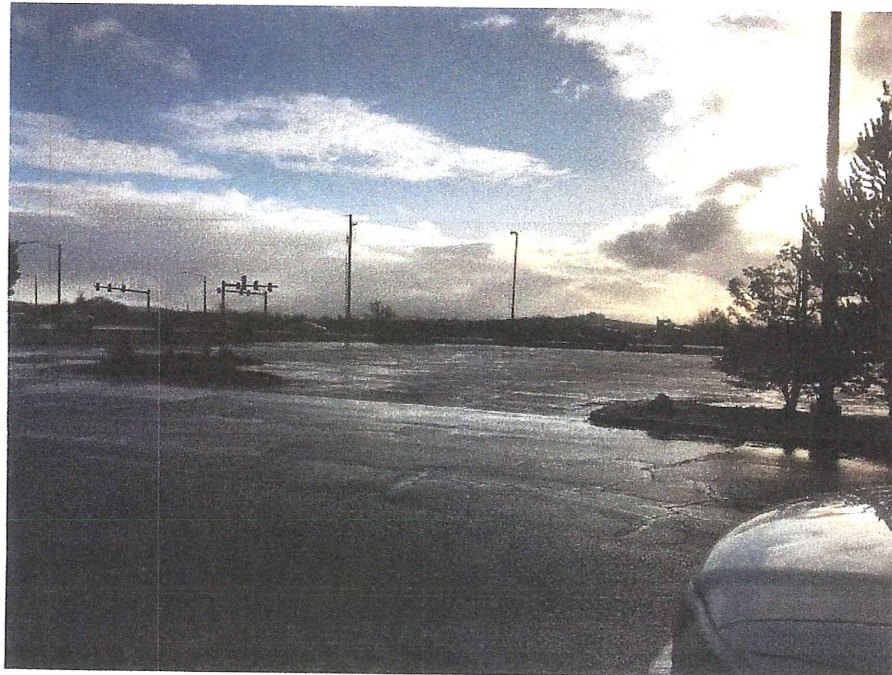

Photo Four

Photo Four Caption NORTHEASTERNLY PARKING LOT - LOCATION PROPOSED NEW

Clear Photo Four

BUILDING PHOTOGRAPHS

See Instructions for Item A6.

OMB No. 1660-0008

Expiration Date: November 30, 2018

ELEVATION CERTIFICATE

IMPORTANT: In these spaces, copy the corresponding information from Section A.			FOR INSURANCE COMPANY USE
Building Street Address (including Apt., Unit, Suite, and/or Bldg. No.) or P.O. Route and Box No. <i>103 South Hwy 101</i>			Policy Number:
City <i>WARRENTON,</i>	State <i>OREGON</i> <input checked="" type="checkbox"/>	ZIP Code <i>97146</i>	Company NAIC Number

If using the Elevation Certificate to obtain NFIP flood insurance, affix at least 2 building photographs below according to the instructions for Item A6. Identify all photographs with date taken; "Front View" and "Rear View"; and, if required, "Right Side View" and "Left Side View." When applicable, photographs must show the foundation with representative examples of the flood openings or vents, as indicated in Section A8. If submitting more photographs than will fit on this page, use the Continuation Page.



FIVE

Photo One

Photo One Caption *LOOKING NORTHWEST - SOUTHEASTERLY CORNER BLDG.* Clear Photo One



34

Photo Two

Photo Two Caption *LOOKING NORTHWESTERLY - SOUTHEASTERLY CORNER BLDG.* Clear Photo Two